



# Sparkling Star Quilt Bag made of machine pieced patchwork

Design & work: Amy Morinaka

Size: 21cm (l) x 21cm (w) x 7cm (d)

have fun with KOKKA fabric! produced by **KOKKA**

**kokka-fabric.com**

The craft projects and works featured in kokka-fabric.com are strictly for personal use and enjoyment.  
Please refrain from selling handmade items using the same exact design (including the pieces made in different fabrics) featured in kokka-fabric.com.

**Instruction** (Please refer to the Matching Piecing Instructions for machine piecing and quilting to prepare a combined two outer fabric pieces and one bottom gusset piece.)

## Materials

- Fabric (Blue solid): 110cm wide×50cm
- Pre-cut patchwork fabric about 12 different designs
- Quilt batting: 100cm×40cm
- Fusible interfacing: 15cm×25cm
- Zipper: 25cm×1
- D Ring: 1cm wide - Two pieces
- Strap: One commercially available strap with two swivel hooks

Fabric shown for this sample: Kokka echino solid, Kokka Irome

## Note

- Seam for patchwork fabric pieces is 0.7cm. Other seams are 1cm.
- Lining fabric is cut 0.5cm shorter than the outer (top) fabric.

## Cutting

### <For patchwork>

- Solid (blue)
- 5cm×5cm blue square pieces - 8
  - 6.3cm×6.3cm square pieces - 8
  - 4.5cm×16.3cm oblong strip piece - 4
  - 4.5cm×22.5cm oblong strip piece - 4

- Patterned (Pre-cut pieces, about 12 designs)
- 5cm×5cm square pieces - 8
  - 6.3cm×6.3cm square pieces - 8
  - 10cm wide remnants for piecework (various designs)

### <Main Bag>

- Solid
- Blue Top gusset (4.5cm×28cm) - 4
  - Lining fabric (25cm×25cm) - 2
  - Bottom gusset (10cm×63cm) - 1
- Patterned
- Pocket 22.5cm×22.5cm square piece - 1
  - Tab (4.5cm×4.5cm) - 2
- Quilt batting
- 25cm×25cm - 2
  - 4.5cm×27.5cm - 2
  - 10cm×63cm - 1
- Fusible interfacing
- 11.3cm×22.5cm - 1

1. Make the pocket and cut the bottom two corners to a round, matching the bag outer fabric (top).

Fusible interfacing (reverse side)  
(half side only)

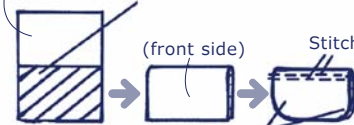

With the front sides facing outside, fold in two. Cut them round to match the bag outer fabric (top).

2. Layer the pocket to the bottom half of the lining fabric for the outer fabric (front top). Set a large stitch size on the sewing machine to baste.

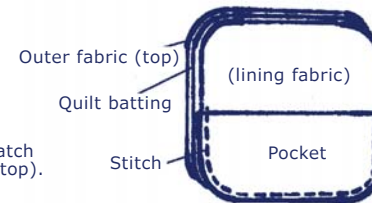

3. Make two tabs. Put through the D ring and sew to make a loop.

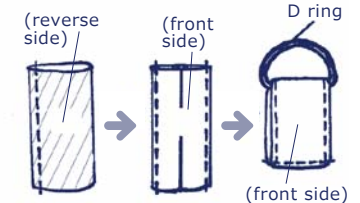

4. In between the outer and lining fabrics of the top gusset, place a zipper and attach it to the gusset. Attach two tabs to the edge of the zipper. Cut the top gusset to 9cm x 28cm.

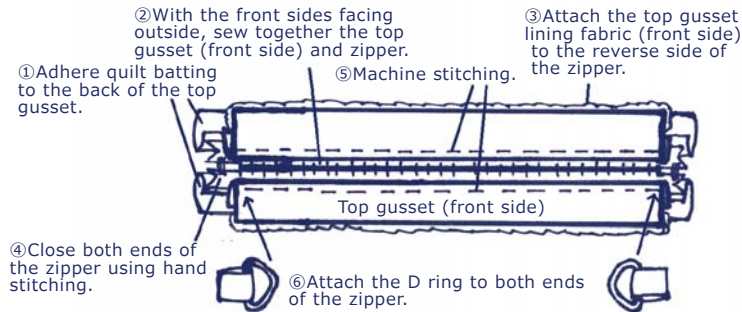

5. With the front sides facing each other, sew together the top and bottom gussets to make a loop.

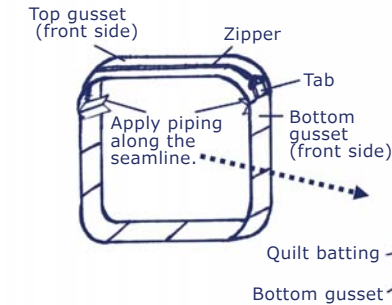

6. Apply piping in two locations where pieces are sewn together.

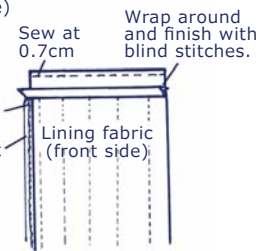

7. Sew together the two pieces of outer fabric (panel) and gusset.

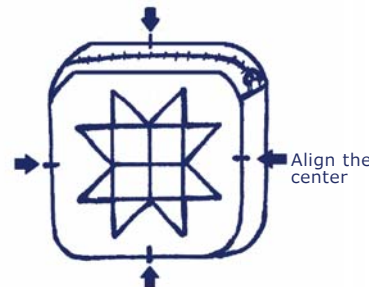

8. Cut off and align the seam. Using the bias binding tape, finish the parameter with piping.

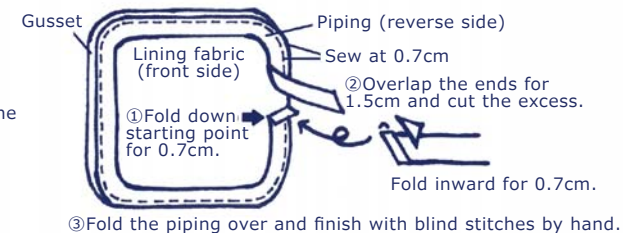

9. Attach the strap with swivel hooks to D ring.

Lining fabric side



# Five Star Bag made of machine pieced patchwork - Sparkling Star Quilt Bag

have fun with KOKKA fabric! produced by **KOKKA**

[kokka-fabric.com](http://kokka-fabric.com)

The craft projects and works featured in kokka-fabric.com are strictly for personal use and enjoyment.  
Please refrain from selling handmade items using the same exact design (including the pieces made in different fabrics) featured in kokka-fabric.com.

## Note

- Seam for patchwork fabric pieces is 0.7cm.
- Include the seam when cutting the fabric.
- Cut all the square pieces and strip fabrics beforehand.
- When machine piecing, there is no need to apply backstitches at the start and finish.
- When sewing the pieces together by a machine, continue to sew without cutting the thread every time a piece is sewn. Separate the pieces after all the sewing is done. This way, you can work faster. (Chain piecing)
- Make the top slightly larger than the measurement. After applying the machine quilting, cut it to the appropriate size.
- Be creative with the machine quilting design. You may try a straight line, wavy style or a circle according to your taste.

## Instructions

- ① As below, create a square block by piecing two fabrics. Make 16 of these pieces.

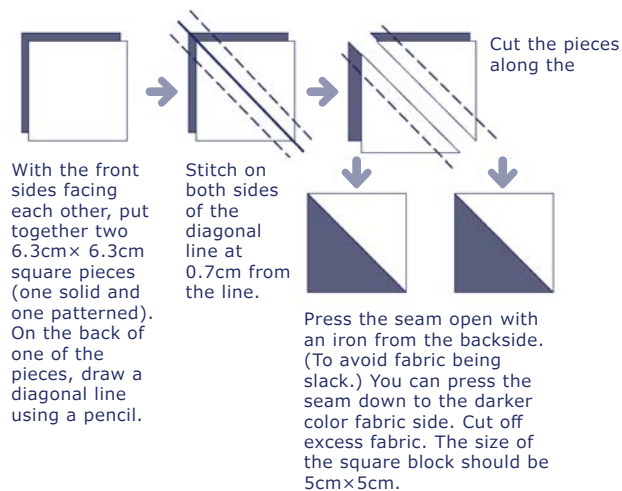

- ② Piece them together line by line to make an outer fabric (top) using the following: Pieced triangle 5cm square block - 8, Patterned 5cm square block - 4, Solid 5cm square block - 4. First, piece together the horizontal line, then piece together lengthwise. After piecing them altogether, cut the panel to a 16.3cm x 16.3cm square. Make two panels.

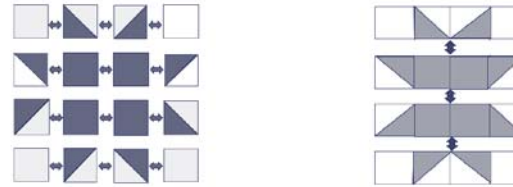

- ③ Attach two solid 4.5cm x 16.3cm strip pieces (narrower one) to the top and bottom first, then attach two 4.5cm x 22.5cm strip pieces (longer one) to the right and left. Repeat the same process for the other top panel.

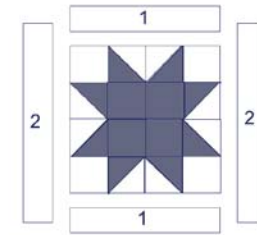

- ④ Layer the top panel, quilt batting and backing fabric and baste them together. Apply machine quilting all over the panel. After quilting, cut it to 22.5cm x 22.5cm. Repeat the same process (quilting and cutting) to the other top panel. Cut all four corners to make them round.

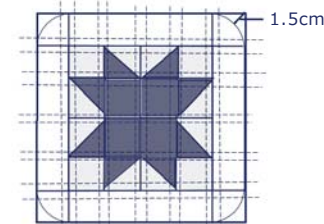

- ⑤ Attach 10cm-wide remnants for piecework to 10cm x 63cm quilt batting to create a bottom gusset (press quilting). With the front sides facing each other, put together the 10cm-wide remnants and sew one end as shown. Press it open using an iron. Repeat the process until all the remnant pieces are attached to the quilt batting.

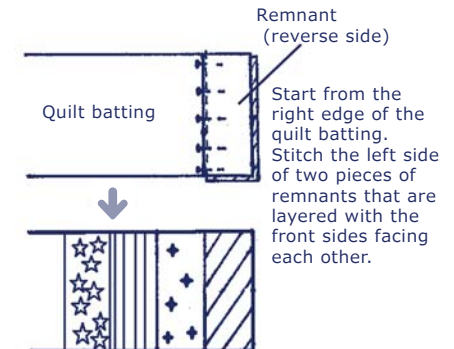

- ⑥ With the front sides facing outside, put together the bottom gusset from step ⑤ and 10cm x 63cm lining fabric and apply machine quilting. Cut it to 9cm x 61cm.



Press it open using an iron. Repeat the process until all the remnant pieces are attached to the quilt batting.